



# Meetings



## QUICK FACTS:

- Georgia Coast's most central conference center – centrally located between Savannah, Pooler, Statesboro & Brunswick.
- 12 Miles from Savannah & 17 Miles from Savannah/Hilton Head International Airport
- Easily accessible from main highways (I-95 & I-16)
- Over 20 branded hotels within a 2-6 mile radius
- Secluded & private
- 10,000 Square-feet of flexible indoor meeting space including 10 breakouts
- For meetings & groups of all sizes up to 350 guests
- 6000 Square-feet of outdoor space
- 4000 Square-foot ballroom with floor to ceiling windows allowing for natural light if you choose or shades can be pulled down
- State-of-the-art audio visual equipment
- Capability & inventory for all different meeting sets
- Complimentary parking
- LEED Registered Meeting center
- Follow IACC Standards



FIRST FLOOR

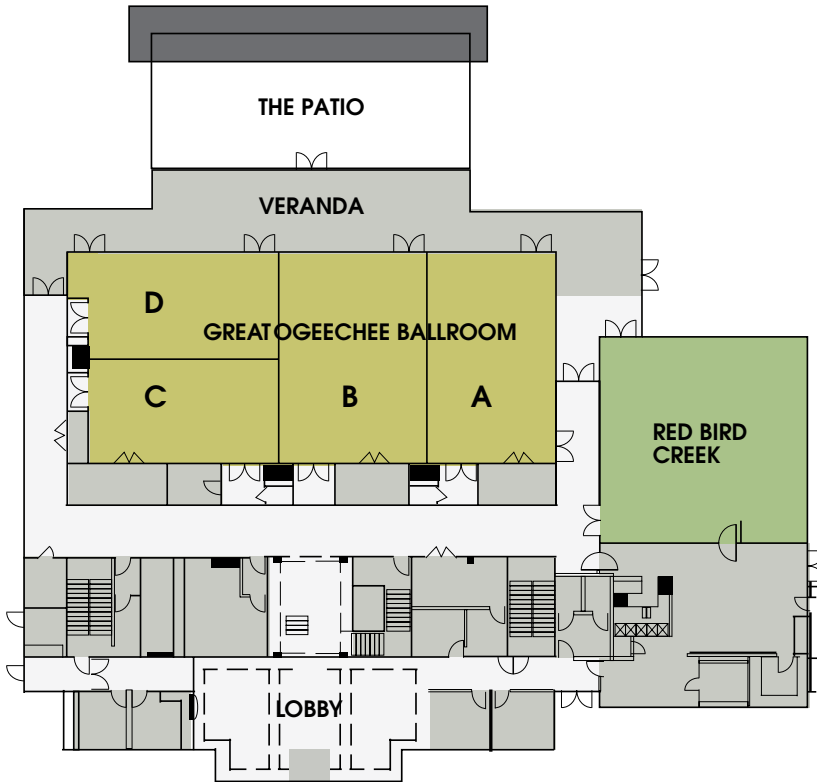

SECOND FLOOR

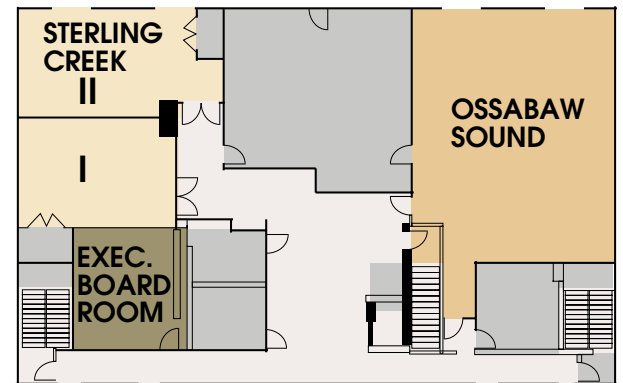

*Capacity per seating arrangement*

NAME OF SPACE	SQ. FT.	DIMEN.	THEATER	CLASSROOM	BANQUET ROUNDS	COCKTAILS
<b>GREAT OGEECHEE BALLROOM</b>	3975	96.3' X 41.3'	430	175	300	400
Gallery A	1100	25.7' X 41.3'	130	50	80	100
Gallery B	1100	28.9' X 41.3'	130	50	80	100
Gallery C	860	41.7' X 20.7'	90	40	70	85
Gallery D	860	41.7' X 20.7'	90	40	70	85
Gallery AB	2250	54.6' X 41.3'	240	94	160	225
Gallery CD	1700	41.7' X 41.3'	180	70	130	160
Gallery BCD	2785	70.6' X 41.3'	300	116	225	265
<b>RED BIRD CREEK</b>	500	41.7' x 39.9'	70	40	64	75
<b>STERLING CREEK</b>	890	25.1' x 35.4'	90	35	60	80
Gallery I	445	25.1' x 17.7'	45	25	24	35
Gallery II	445	21.1' X 17.7'	45	25	24	35
<b>OSSABAW SOUND</b>	1344	32.8' x 41'	130	60	100	130
<b>EXECUTIVE BOARD ROOM</b>	350	18.1' x 19.2'	10-12	N/A	N/A	N/A
<b>THE VERANDA</b>	2004		N/A	N/A	60	200
<b>THE PATIO</b>	2700	60' x 45'	200	N/A	160	200